

MINIATURE SWITCHES WITH POSITIVE OPENING AND SELF-CLEANING CONTACTS VC Series

Features

- Industry standard design with 11A ratings
- Choose from a variety of levers, terminals
- Positive opening and self-cleaning contacts
- Long service life of 10,000,000 operations
- RoHS Compliant
- IP67 rated model available

Specifications

Operating Speed	0.01mm to 1m/sec (Plunger models without levers)
Operating Frequency	Mechanical: 120 ops/min; Electrical: 60 ops/min
Service Life	Mechanical: 10,000,000 (operations) Electrical: 500,000 (operations) min, at rated current
Rated Current/Voltage	0.1A, 3A, 5A, 10A(Prewired version), 11A 1/2HP 125/250VAC
Operating Temperature	-40~+85°C
Dielectric Strength	1,000 VAC, 50/60 Hz for 1 min between terminals of the same polarity 2,500 VAC, 50/60 Hz for 1 min between current-carrying metal parts and ground, and between each terminal and non-current-carrying metal parts
Insulation Resistance	>100MΩ @500VDC
Contact Resistance	<25MΩ (Initial value)
Degree of Protection	IP40, IP60 for sealed version, IP67 for prewired version

Selection Guide:

VC	11	Sealing	Actuator	G	Terminal Type	Cable Length Number	Cable Length Unit	Contact Configuration	Options
Current A		G None W Sealed	None Pin plunger 1 Short hinge lever 2 Hinge lever 3 Long hinge lever 4 Simulated roller lever 5 Short metal roller lever 5P Short plastic roller lever 6 Metal roller lever 6P Plastic roller lever 7 Simulated roller lever(long) 8 Long hinge lever with bend	Max. Operating Force 300g	C 0.25x0.03 Tab P Short Pin R Fly leads U Sealed Cable		None None M Meter(s) F Foot/feet	None 1NO/1NC 1 1NO contact 2 1NC contact	None Silver contact K Gold contact

*For prewired version, current rating is 10A due to the wire gauge

Wiring Diagram:

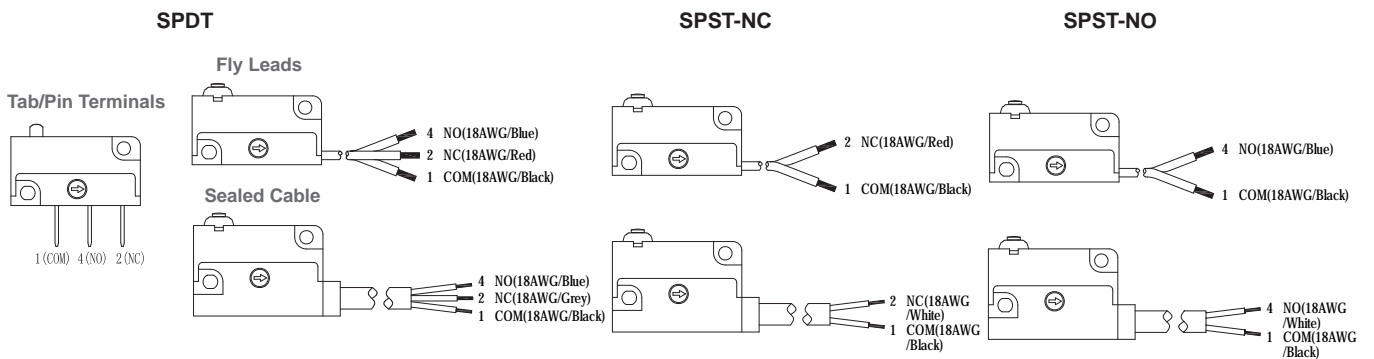

Pictures and Dimensions:

VC11GG-C

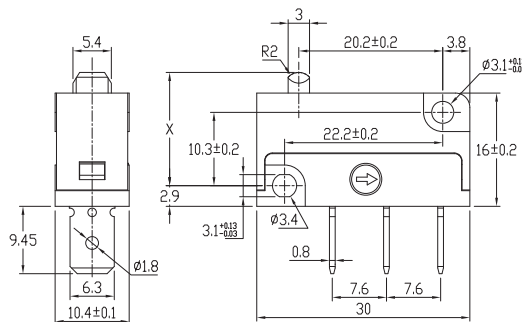
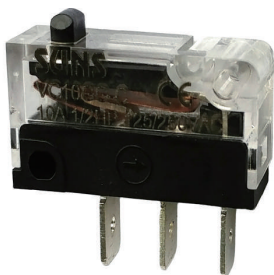

Operating Characteristics

- OF_{max} 2.94N (11oz)
- FP 16.0±0.1mm (0.630±0.004in.)
- OT 1.8mm (0.071in.)
- OP 14.8±0.2mm (0.583±0.008in.)
- MD 0.3mm (0.012in.)
- PO 2.7mm (0.106in.)

MINIATURE SWITCHES WITH POSITIVE OPENING AND SELF-CLEANING CONTACTS

VC Series

Actuating Styles (mm):

<p>-1 Short hinge lever</p> <p>Operating Characteristics</p> <ul style="list-style-type: none"> • OF_{max} 2.78 N (10 oz) • FP 17.5±0.2mm (0.689±0.008in.) • OT 2.5mm (0.098in.) • OP 15.9±0.3mm (0.626±0.012in.) • MD 0.3mm (0.012in.) • PO 3.8mm (0.150in.) 	<p>-2 Hinge lever</p> <p>Operating Characteristics</p> <ul style="list-style-type: none"> • OF_{max} 1.53 N (5.5 oz) • FP 19.0±0.25mm (0.748±0.010in.) • OT 3.5mm (0.138in.) • OP 16.7±0.35mm (0.657±0.014in.) • MD 0.3mm (0.012in.) • PO 5.5mm (0.217in.)
<p>-3 Long hinge lever</p> <p>Operating Characteristics</p> <ul style="list-style-type: none"> • OF_{max} 0.75 N (2.7 oz) • FP 21.4±0.3mm (0.843±0.012in.) • OT 5.1mm (0.201in.) • OP 18.0±0.4mm (0.709±0.016in.) • MD 0.3mm (0.012in.) • PO 8.2mm (0.323in.) 	<p>-4 Simulated roller lever</p> <p>Operating Characteristics</p> <ul style="list-style-type: none"> • OF_{max} 2.78 N (10 oz) • FP 22.4±0.3mm (0.882±0.012in.) • OT 2.1mm (0.083in.) • OP 21.1±0.4mm (0.831±0.016in.) • MD 0.3mm (0.012in.) • PO 3.1mm (0.122in.)
<p>-5 Short hinge roller lever</p> <p>Operating Characteristics</p> <ul style="list-style-type: none"> • OF_{max} 2.94N (11oz) • FP 21.9±0.3mm (0.862±0.012in.) • OT 1.7mm (0.067in.) • OP 20.7±0.4mm (0.815±0.016in.) • MD 0.3mm (0.012in.) • PO 2.6mm (0.102in.) 	<p>-6 Hinge roller lever</p> <p>Operating Characteristics</p> <ul style="list-style-type: none"> • OF_{max} 2.50 N (9 oz) • FP 22.4±0.3mm (0.882±0.012in.) • OT 2.1mm (0.083in.) • OP 21.1±0.4mm (0.831±0.016in.) • MD 0.3mm (0.012in.) • PO 3.1mm (0.122in.)

Terminal Styles (mm):

<p>-P Short pin</p>	<p>-U Sealed cable</p>	<p>-R Fly leads</p>
---------------------------------------	--	---------------------------------------