

DOUBLE POLE DOUBLE THROW MICRO SWITCHES ZD-10 SERIES

Specifications

Operating Speed	0.01mm-1m/sec
Operating Frequency	Mechanical: 240ops/min Electrical: 20 ops/min
Insulation Resistance	>100MΩ@500V DC
Contact Resistance	<15mΩ
Rated Current/Voltage	10A 1/2HP 125/250VAC, 2A 480VAC, 0.5A 125VDC, 0.25A 250VDC
Dielectric Strength	1000VAC for 1 min between current carrying parts 1500VAC for 1 min between non-current carrying parts
Service Life	Mechanically 1.0 x10 ⁶ (operations) Electrically 5 x10 ⁵ (operations)
Operating Temperature	-25~+80°C (-13~176°F)
Humidity	35%~85%RH
Degree of Protection	IP00

Definitions of Operating Characteristics

OF Operating Force PT Pretravel
 RF Releasing Force MD Movement Differential
 OT Overtravel OP Operating Position
 TT Total Travel PO Travel to Positive Opening

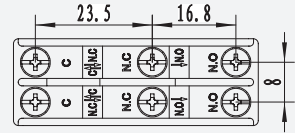

Ratings

Item	Non-inductive load (A)				Inductive load (A)			
	Resistive load		Bulb load		Inductive load		Motor load	
	NC	NO	NC	NO	NC	NO	NC	NO
Series Connection	AC125 250	10	4	2	6	5	2.5	
		10	2.5	1.5	6	3	1.5	
	DC 30 125 250	10	4	2	6	6	3	
		1	1	1	0.1	0.1	0.1	
Parallel Connection	AC125 250	6	3	1.5	4	4	2	
		6	2.5	1.25	4	2	1	
	DC 30 125 250	6	4	2	4	6	3	
		0.6	0.6	0.6	0.1	0.1	0.1	
		0.3	0.3	0.3	0.05	0.05	0.05	

Dimensions Unit: mm

ZD-10G

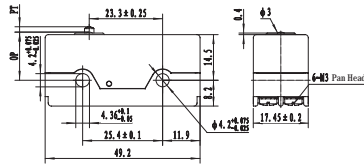

Operating Characteristics

- OF_{max} 5.59N
- RF_{min} 0.56N
- PT_{max} 1.7mm
- OT_{min} 0.13mm
- MD_{max} 0.4mm
- OP 15.6°*0.4mm

ZD-10GV

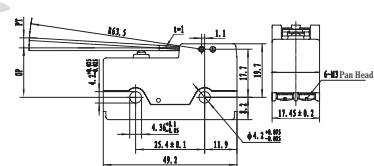

Operating Characteristics

- OF_{max} 1.96N
- RF_{min} 0.13N
- PT_{max} 6mm
- OT_{min} 0.4mm
- MD_{max} 1.7mm
- OP 18.3°*1mm

ZD-10GW

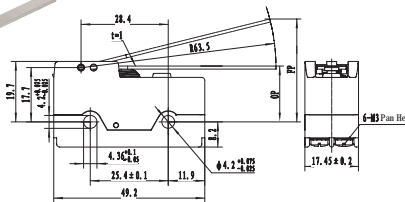
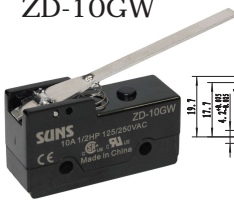

Operating Characteristics

- OF_{max} 1.67N
- RF_{min} 0.27N
- OT_{min} 1.6mm
- MD_{max} 4mm
- FP_{max} 34mm
- OP 18.3°*1mm

ZD-10GW1

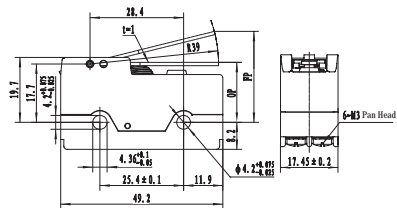

Operating Characteristics

- OF_{max} 2.7N
- RF_{min} 0.65N
- OT_{min} 1.6mm
- MD_{max} 4mm
- FP_{max} 28mm
- OP 18.3°*1mm

ZD-10GV1

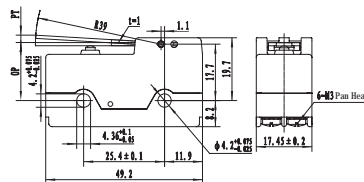

Operating Characteristics

- OF_{max} 3N
- RF_{min} 0.45N
- OT_{min} 0.4mm
- MD_{max} 1.2mm
- PT_{max} 4mm
- OP 18.3°*1mm

ZD-10GV2

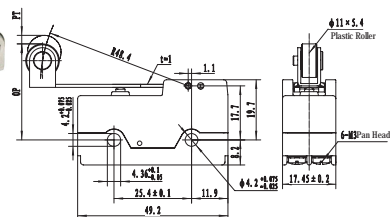

Operating Characteristics

- OF_{max} 2.65N
- RF_{min} 0.33N
- OT_{min} 0.26mm
- MD_{max} 1.1mm
- PT_{max} 4mm
- OP 29.4°*0.8mm

DOUBLE POLE DOUBLE THROW MICRO SWITCHES ZD-10 SERIES

<p>ZD-10GW2 Operating Characteristics</p> <ul style="list-style-type: none"> • OF_{max} 2.09N • RF_{min} 0.41N • OT_{min} 1.2mm • FP_{max} 45mm • MD_{max} 3.3mm • OP 31.8*0.8mm 	<p>ZD-10GW22 Operating Characteristics</p> <ul style="list-style-type: none"> • OF_{max} 3.92N • RF_{min} 0.839N • OT_{min} 0.9mm • FP_{max} 39.7mm • MD_{max} 2.4mm • OP 30.2*0.8mm
<p>ZD-10GV22 Operating Characteristics</p> <ul style="list-style-type: none"> • OF_{max} 4.22N • RF_{min} 0.41N • PT_{max} 3mm • OT_{min} 0.13mm • MD_{max} 0.6mm • OP 29.4*0.8mm 	